

LED-Einbauleuchte 100-240V 50/60Hz

- Betriebsart: Hochvolt
- mit COB LED
- Aluminiumprofil
- sichtbare Höhe nur 3,3mm
- geeignet zum Einbau in 19mm Plattenmaterial
- integrierter LED-Treiber
- 2500mm Zuleitung mit Ministecker für Bohrung \varnothing 8mm
- nicht dimmbar
- Klemmbefestigung
- Schutzklasse II

Recessed LED light 100-240V 50/60Hz

- operating mode: mains voltage
- with COB LED
- aluminium profile
- visible height 3,3mm only
- suitable for 19mm boards
- integrated LED driver
- 2500mm lead with mini male plug for \varnothing 8mm
- not dimmable
- push-fit installation
- protection class II

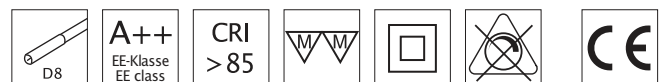
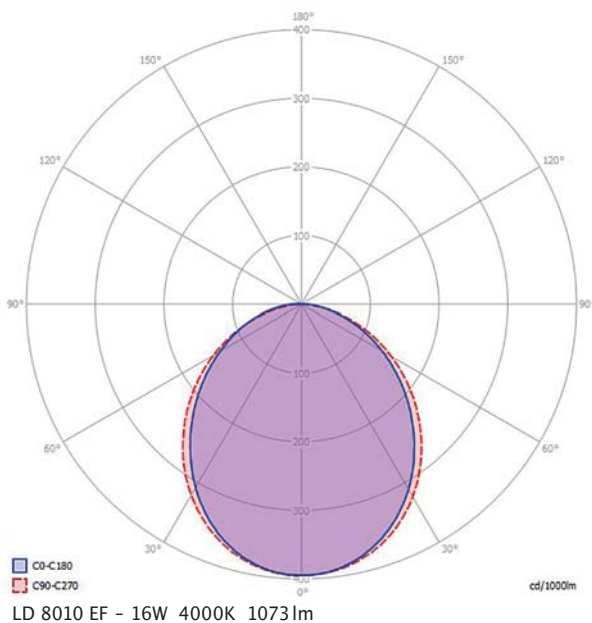
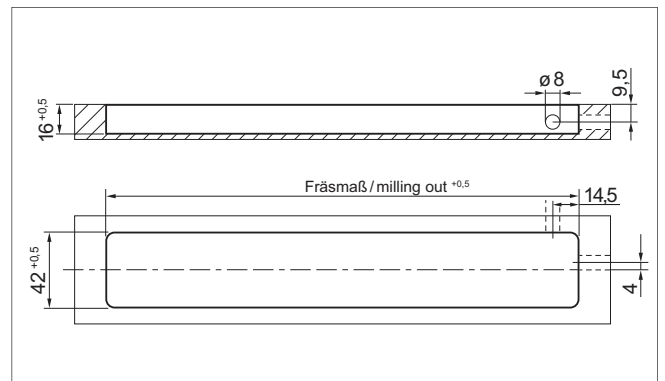
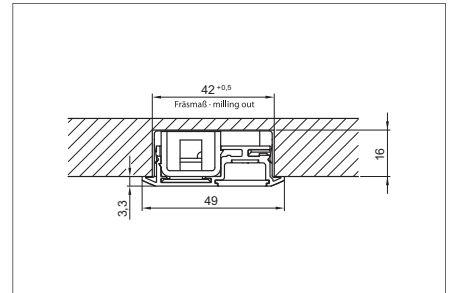
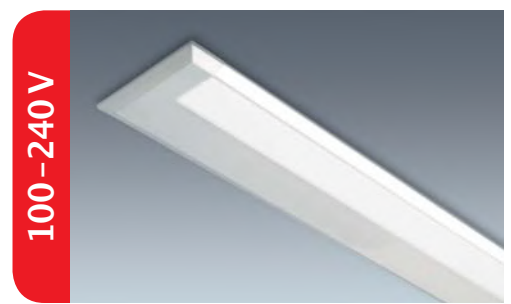

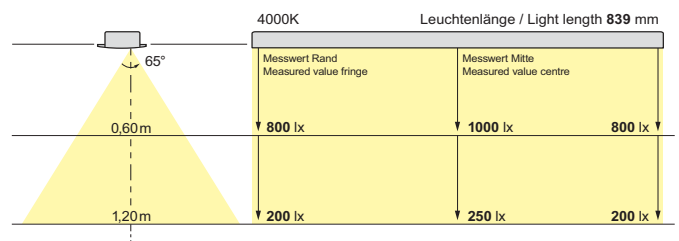

Produktinformationen:
Product information:





Art.-Nr. Art. No.	Lichtfarbe Light colour	Spannung Voltage	Leistung Wattage	Länge Length	Fräsmaß Milling out	Gewicht Weight
538 360 01	3000K	100-240V	6,0W	334mm	327mm	306g
538 360 02	3000K	100-240V	7,5W	434mm	427mm	352g
538 360 03	3000K	100-240V	9,5W	535mm	528mm	420g
538 360 04	3000K	100-240V	14,5W	839mm	832mm	571g
538 360 05	3000K	100-240V	16,0W	939mm	932mm	610g
538 360 11	4000K	100-240V	6,0W	334mm	327mm	306g
538 360 12	4000K	100-240V	7,5W	434mm	427mm	352g
538 360 13	4000K	100-240V	9,5W	535mm	528mm	420g
538 360 14	4000K	100-240V	14,5W	839mm	832mm	571g
538 360 15	4000K	100-240V	16,0W	939mm	932mm	610g

Zubehör Accessories

Zuleitung mit Minibuchse Supply lead with mini female socket 531 115 01 3000mm		116g	Weitere Längen im Kapitel „Stecksysteme“. Other lengths see chapter „Connector Systems“.
Zuleitung mit Verteiler 6-fach Supply lead with 6-way distributor 531 116 01 3000mm		141g	Weitere Längen im Kapitel „Stecksysteme“. Other lengths see chapter „Connector Systems“.